



M/Y SILENT GRACE

62', 2025 100% ELECTRIC SILENT YACHTS CATAMARAN | 8 GUESTS IN 4 CABINS

SILENT GRACE

THE MEDITERRANEAN

This is the Mediterranean, charged differently.

SILENT GRACE is a three-deck solar catamaran redefining chartering in the Med. Based on the award-winning SY62 3-Deck model—awarded Most Efficient Yacht at the 2024 Cannes Yachting Festival—she delivers everything you expect from a charter: beach clubs, nightlife, freedom and escape. But she does it in harmony with the sea. No engine noise. No fumes. Powered entirely by solar energy, she leaves nothing behind, letting you cruise in perfect rhythm with the sea and without compromise.

Life aboard SILENT GRACE is shaped around how you want to spend your days. Stretch out on the 60m² top deck with its dining area, sun pads, and sweeping 360° views, or come together in the bright 50m² saloon for meals and relaxation. Four spacious en-suite cabins welcome up to eight guests, including a spacious master suite in the port hull with enhanced width and large windows, as well as a flexible twin-to-queen arrangement. Outdoors, alfresco dining and foredeck lounging blend seamlessly with time on the water—whether that's Sea scooters, kayaks, towables, or simply a swim. For quieter moments, yoga on deck, Technogym sessions, or the resonance of a Crystal Singing Bowl bring balance to the experience.





TENDER & TOYS

- Highfield Classic 360, 30hp 3.6m tender
- 4 x Robosea Seaflyer sea scooters
- 3 x Bluefin Cruise Carbon SUPs
- 2 x Spinera Hybris kayaks
- 1 x Jobe Chipper towable
- 2 x telescopic fishing sets
- Snorkelling gear

“SILENT GRACE combines award-winning efficiency with the full Mediterranean charter lifestyle. Expansive decks, spacious cabins, and a wealth of water toys ensure every guest is catered for, while her solar power and silent cruising make her an exceptional choice for those seeking comfort, style, and sustainability.”

SPECIFICATIONS

GUESTS	8
CABINS	4
CABIN CONFIGURATION	3 Double, 1 Convertible
CREW	2/3
BUILDER	Silent Yachts
LENGTH	18.90m (62')
BEAM	8.99m (29' 6")
DRAFT	1.3m (4' 2")
YEAR BUILT	2025
ENGINES	2 x 340 Kw electric
CRUISING SPEED	7 knots
FUEL CONSUMPTION	15 LpH for generators, 100% solar energy powered sailing



Weekly Rate From
€40,000 p/week



FLYBRIDGE



FLYBRIDGE



FLYBRIDGE



FLYBRIDGE



FLYBRIDGE



AFT DECK



HYDRAULIC SWIM PLATFORM



BOW



BOW



SILENT GRACE UNDERWAY



MAIN SALON



MAIN SALON



MAIN SALON



SILENT GRACE AT SUNSET



MASTER CABIN



MASTER CABIN



MASTER CABIN



MASTER ENSUITE



VIP CABIN



VIP CABIN



VIP ENSUITE



GUEST DOUBLE CABIN



GUEST DOUBLE ENSUITE



GUEST DOUBLE ENSUITE



GUEST TWIN/CONVERTIBLE DOUBLE CABIN



GUEST TWIN/CONVERTIBLE DOUBLE ENSUITE

SILENT GRACE

YACHT LAYOUT

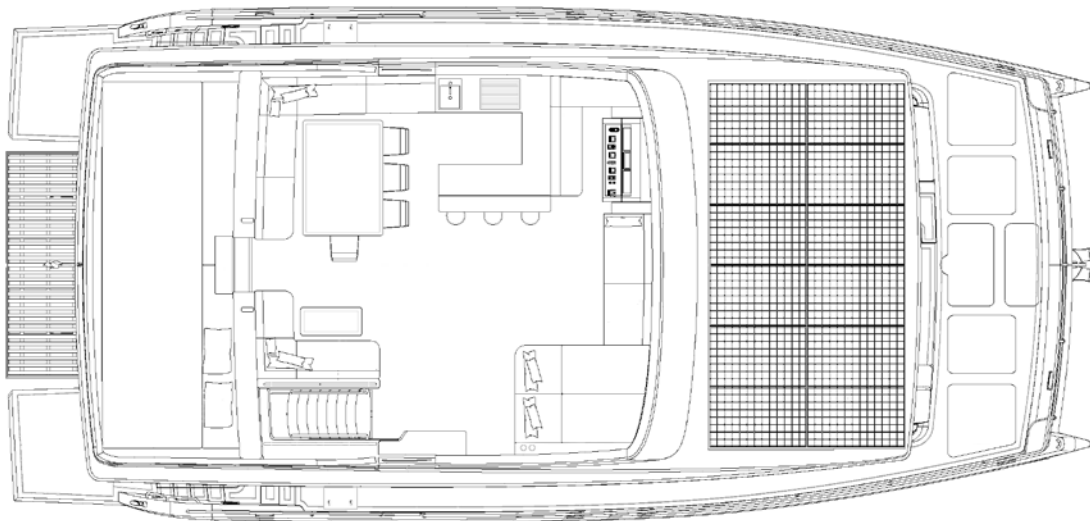

FLYBRIDGE

- 60m² flybridge with 360° views
- 2 large double sunpads aft
- Custom daybed forward
- Lounge area
- Fully equipped bar
- Helm station
- Dining area

SILENT GRACE

YACHT LAYOUT

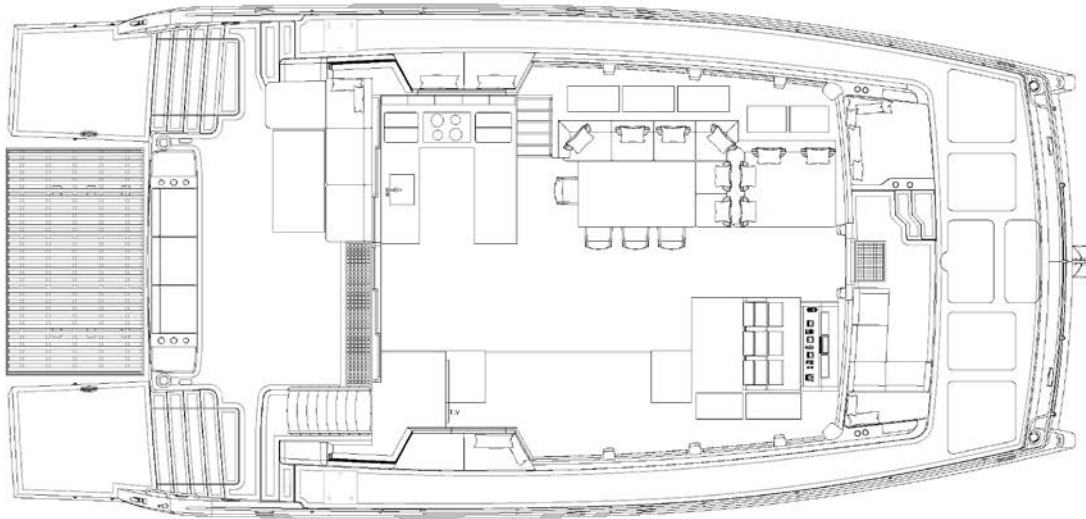

MAIN DECK

- 50m² salon with wrap around windows
- Open plan galley with service hatch to cockpit
- Dining area
- Helm station
- Aft cockpit with dining and lounge area
- Hydraulic swim platform
- Forward bow area with seating and sunpad

SILENT GRACE

YACHT LAYOUT

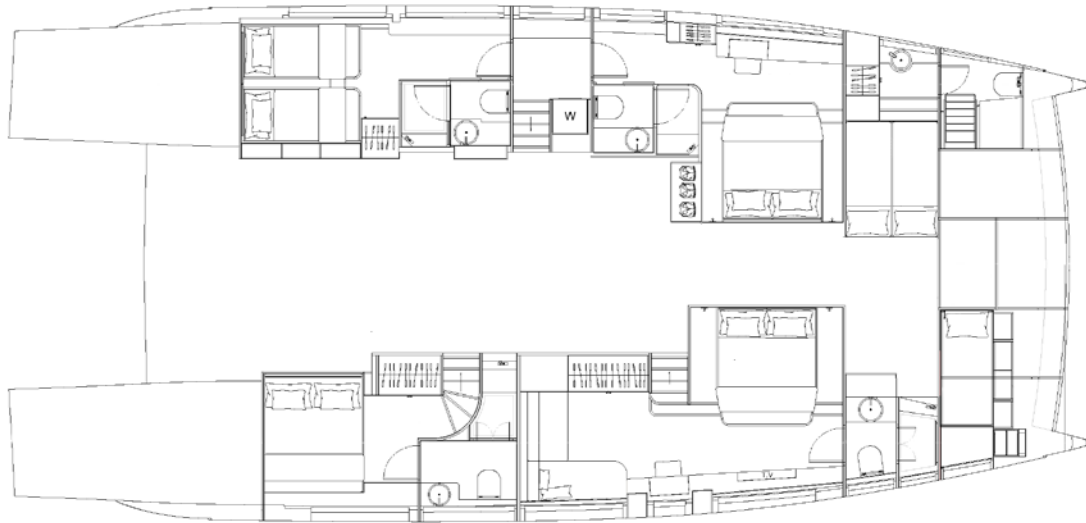

LOWER DECK

- All cabins include a private en-suite and are equipped with air conditioning
- 20m² master cabin with lounge area and vanity station
- VIP double cabin with vanity station
- Double guest cabin
- Twin cabin that can be converted into a queen-sized double cabin
- 2 dedicated crew cabins

This document is not contractual. All specifications are given in good faith and offered for informational purposes only. The publisher and company do not warrant or assume any legal liability or responsibility for the accuracy, completeness, or usefulness of any information and/or images displayed. Yacht inventory, specifications and prices are subject to change without prior notice.

None of the text and/or images used in this brochure may be reproduced without written consent from the publisher.